

UNIT, DIRECT SUPPORT, AND GENERAL SUPPORT MAINTENANCE
REPAIR PARTS AND SPECIAL TOOLS LIST
TRUCK, 5-TON, 6X6, M809 SERIES TRUCKS (DIESEL)

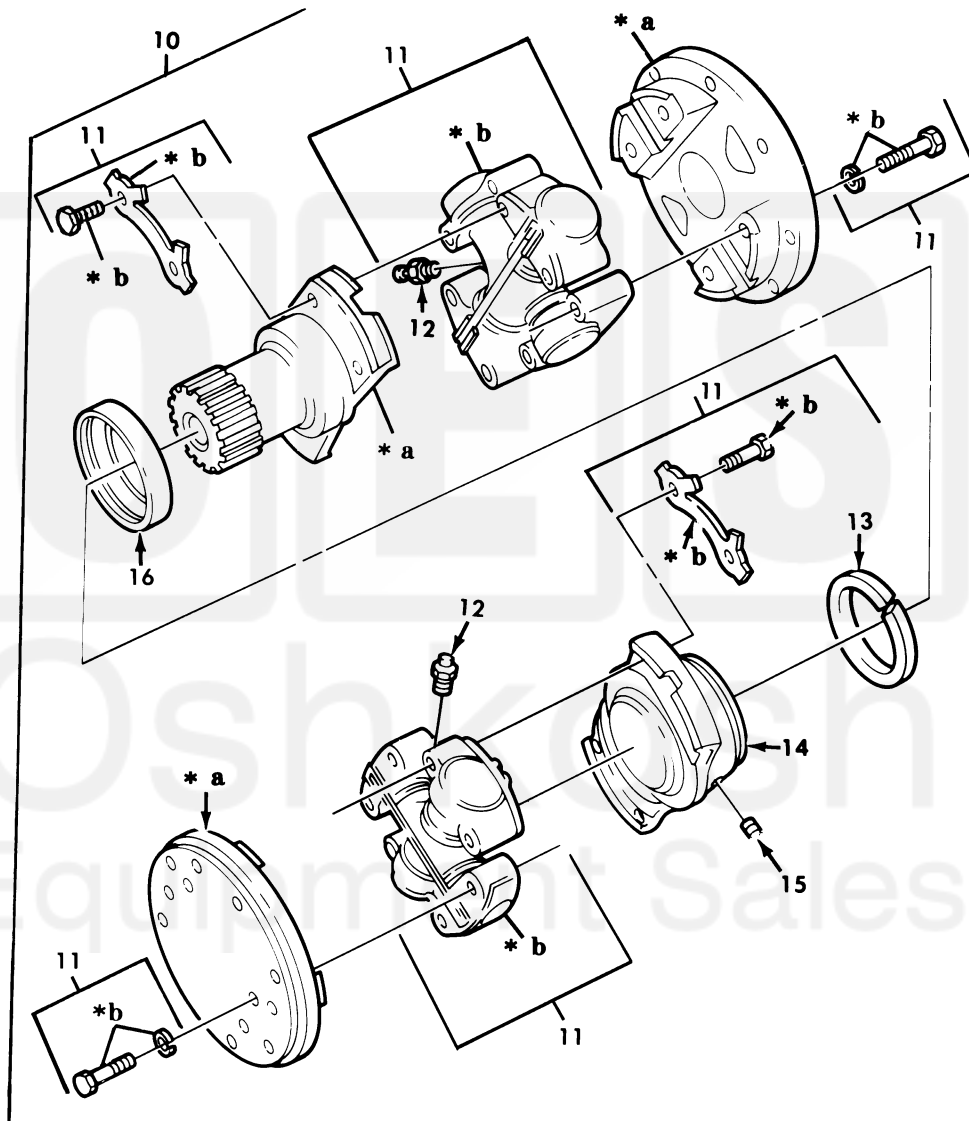

* a PART OF ITEM 10

* b PART OF ITEM 11

Figure 150. Propellor Shaft Assembly, Transmission to Transfer Shaft (Mechanic's) (Sheet 2 of 2)

(1) ITEM NO	(2) SMR CODE	(3) NSN	(4) CAGEC	(5) PART NUMBER	(6) DESCRIPTION AND USABLE ON CODE (UOC)	(7) QTY
GROUP 0900 PROPELLER SHAFTS						
FIG. 150 PROPELLER SHAFT ASSEMBLY, TRANSMISSION TO TRANSFER SHAFT						
1	PAOZZ	5310-00-982-4908	96906	MS21045-6	NUT, SELF-LOCKING, HE.....	16
2	PAOZZ	5306-00-720-8747	96906	MS20073-06-12	BOLT, MACHINE.....	16
3	PAOOO	2520-00-901-9681	77873	2A17549-1	PROPELLER SHAFT WIT TRANSMISSION TO TRANSFER TRANSMISSION (DANA).....	1
4	PAOZZ	2520-01-082-8619	78500	CP280X	.PARTS KIT, UNIVERSAL.....	2
5	PAOZZ	4730-00-050-4203	96906	MS15001-1	.. FITTING, LUBRICATION.....	1
6	PAOZZ	4730-00-050-4208	96906	MS15003-1	. FITTING, LUBRICATION.....	1
7	PAOZZ	5330-00-470-2108	19207	5214482	. PACKING, PREFORMED.....	1
8	PAOZZ	5310-00-582-8816	95019	5-15-33	. WASHER, SPLIT.....	1
9	PAOZZ	2520-00-521-4480	72447	5-14-29	. CAP, DUST, PROPELLER.....	1
10	PAOOO	2520-00-901-9681	77873	2A17549-1	PROPELLER SHAFT WIT TRANSMISSION TO TRANSFER TRANSMISSION (MECHANICS)...	1
11	PAOZZ	2520-00-766-7607	79410	114-7205	.PARTS KIT, UNIVERSAL.....	2
12	PAOZZ	4730-00-050-4208	96906	MS15003-1	. FITTING, LUBRICATION.....	1
13	PAOZZ	5330-00-734-8848	77873	8539J	. FELT, MECHANICAL, PRE.....	1
14	XDOZZ		77873	6A7027	. YOKE, UNIVERSAL JOIN.....	1
15	PAOZZ	4730-00-018-9566	81348	WW-P-471ACABCA	. PLUG, PIPE.....	1
16	PAOZZ	5330-01-119-5680	77873	8533J	. RETAINER, UNIVERSAL.....	1

END OF FIGURE

